



# In-Line Chlorinator

## Instructions for Installation

JED #460 – Small In-Line holds up to 4.2 lbs. of Tri-Chlor Tabs

JED #470 - Large In-Line holds up to 9 lbs. of Tri-Chlor Tabs

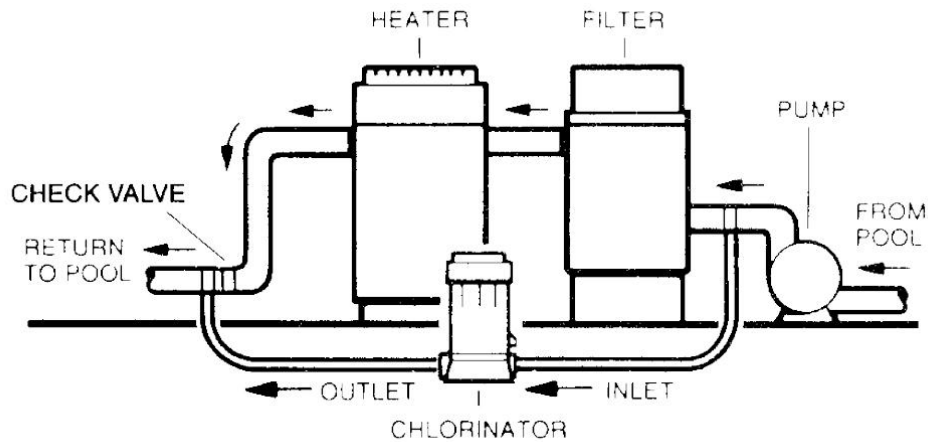
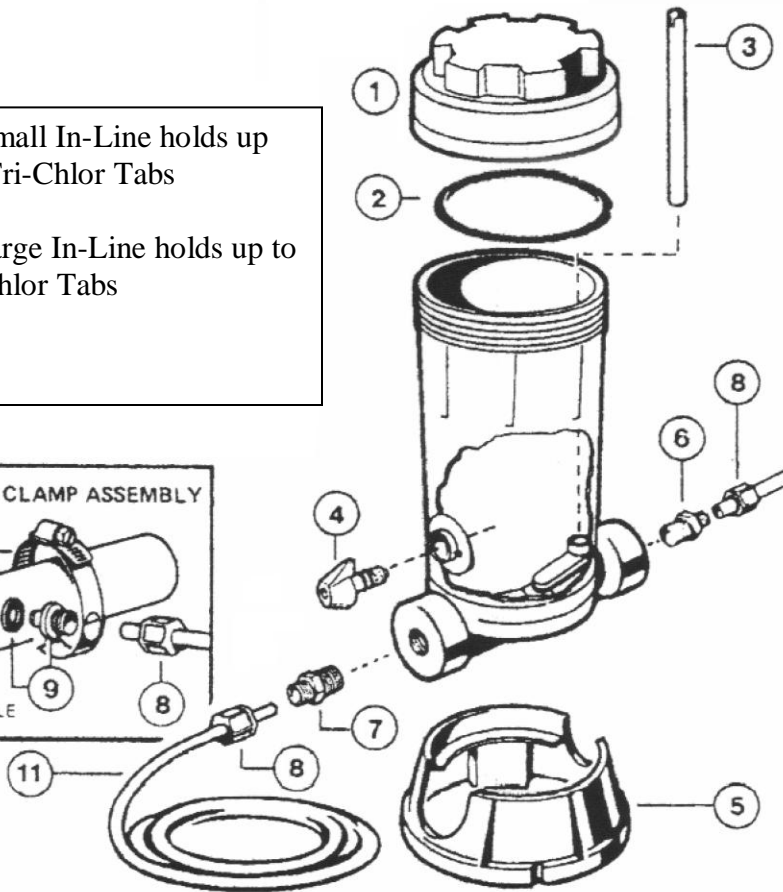
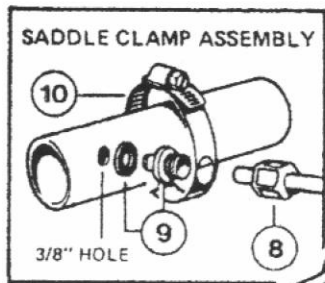

[www.JEDPoolTools.com](http://www.JEDPoolTools.com)  
[info@JEDPoolTools.com](mailto:info@JEDPoolTools.com)

1100 Penn Ave Scranton, PA 18509



# In-Line Chlorinator

## Instructions for Installation

### **Cautions:**

**Never mix with other types of chlorine chemicals; explosion or fire may occur. Always read the chlorine label and carefully follow the manufacturer's directions. Use this chlorinator with slow dissolving chlorine tabs only. Open chlorinator ONLY when pump is turned OFF!**

### **Placement and Installation**

1. JED #460 and #470 In-Line Chlorinators are furnished with a 1-1/2" FPT Threaded Inlet and Outlet fittings for In-Line Installation. Install on flat or rigid surface, ideally above water level and below the filter or heater inlets.
2. Install the Chlorinator with water flow direction as indicated on the Chlorinator.
3. After connections are made, start pump and check for leaks.  
Retighten as necessary—DO NOT TIGHTEN CONNECTIONS WITH PUMP ON.

### **To Fill Chlorinator**

1. Shut pump off
2. Turn top cap to Left
3. Lift cap off
4. Insert Trichloro-S-Triazinetrione tablets (slow release tablets)
5. Replace cap and turn to Right

### **Chlorinator Adjustments**

The Regulating Knob allows control and adjustment of the rate of feed of chlorinated water in order to meet the variable pool water conditions and demand.