



Off Line Chlorinator

Instructions for Installation

Cautions

Never mix with other types of chlorine chemicals; explosion or fire may occur.
Use this chlorinator with slow dissolving chlorine tabs only.
Open chlorinator **ONLY** when pump is turned OFF!

Placement and Installation

1. Place Chlorinator on flat surface ideally above water level and below the filter or heater inlets.
2. **INLET** Mark pipe for connection in the piping **AFTER** the pump and **BEFORE** the filter.
3. **OUTLET** Mark pipe for connection in the piping **AFTER** the heater and **AFTER** the filter.
4. Cut the 2 lengths of tubing (#11) the proper size to make connections from pipe to chlorinator.
5. Wrap large male thread of the Inlet Fitting (#7) with Teflon tape and thread inlet fitting securely into inlet side of chlorinator.
6. Wrap large male thread of the Check Valve (#6 and identified by an inner ball that “clicks” when shaken) with Teflon tape and thread Check Valve securely into outlet side of chlorinator.
7. Connect tubing (#11) to chlorinator by placing Compression Nut (#8) over inlet tubing and slide nut up about 1”. Fit tube securely into the adapter socket, **HAND TIGHTEN** nut. Do not over-tighten.
8. Repeat above to make outlet connection.

Saddle Fitting Assembly (will fit either 1 ½” or 2” piping)

INLET Connection:

Connection spot marked in step 2 – After the pump and before the filter.

9. Drill 3/8” hole in pipe.
10. Clean away shavings.
11. Place Saddle Fitting and Gasket (#9) into shaped hole in Saddle Clamp (#10) and insert into 3/8” hole.
12. Tighten to achieve good seal. **DO NOT OVER TIGHTEN CLAMP.**
13. Connect inlet tubing (#11) to Saddle Fitting by placing Compression Nut (#8) over inlet tubing and slide nut up about 1”. Fit tube securely into the fitting socket, **HAND TIGHTEN** nut.
Do not over-tighten

OUTLET Connection:

Connection spot marked in step 3 - After the heater and after the filter. Repeat above steps 9 -13 above for the marked spot for outlet connection.

After connections are made, start pump and check for leaks. Retighten as necessary—**DO NOT TIGHTEN CONNECTIONS WITH PUMP ON.**

To Fill Chlorinator

1. Shut pump off
2. Turn top cap to Left
3. Lift cap off
4. Insert Trichloro-S-Triazinetrione tablets (slow release tablets)
5. Replace cap and turn to Right



Off Line Chlorinator

Instructions for Installation

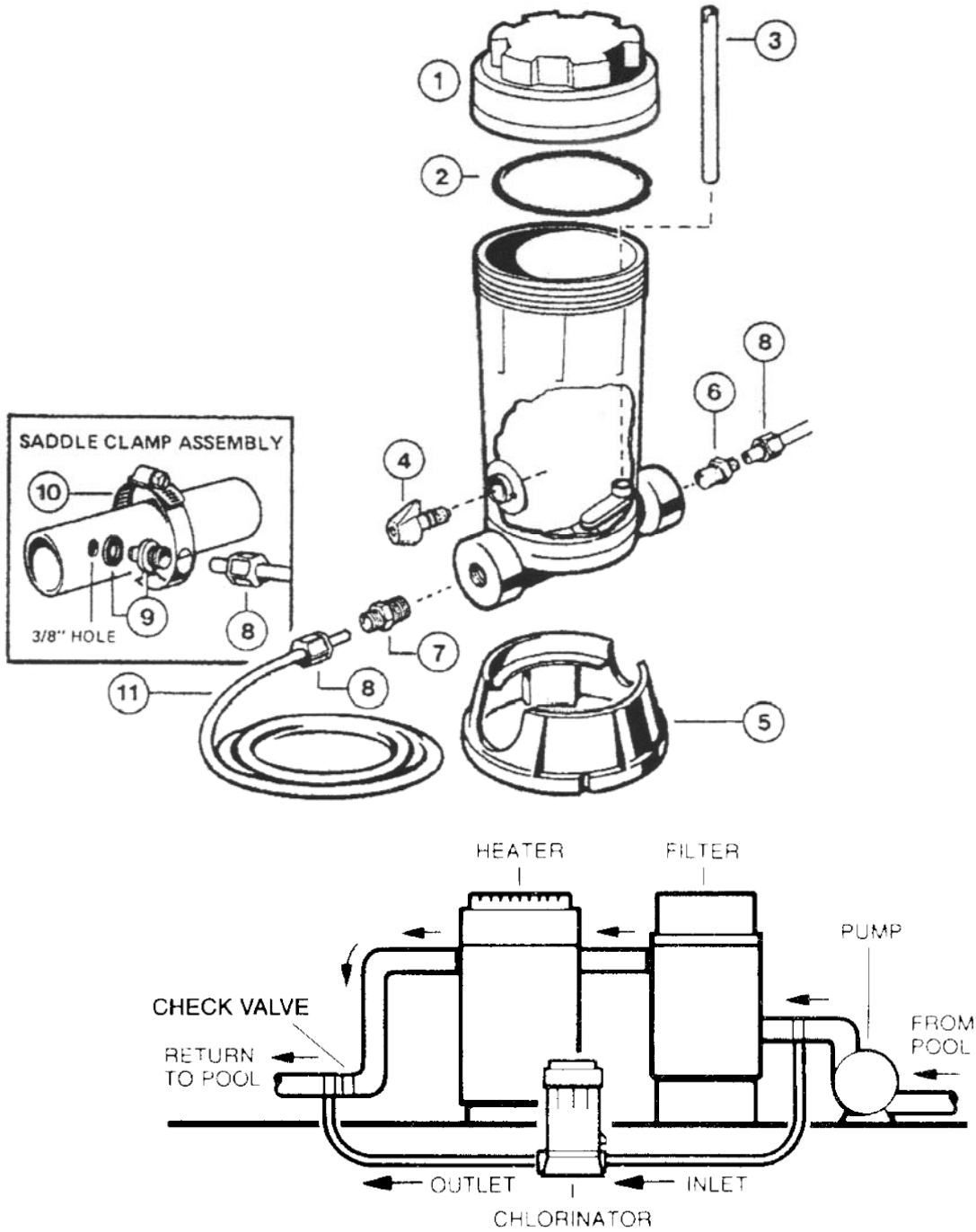

www.JEDPoolTools.com
info@JEDPoolTools.com
1100 Penn Ave Scranton, PA 18509